



*Colour your Style*

**aQuasanit®**



# Colour your Style

**Creare armonia nello spazio del bagno significa anche scegliere prodotti coordinati, che seguono lo stesso stile e lo stesso design, per poter sviluppare in seguito un ambiente attentamente studiato e curato.**

**La collezione Colour your Style raggruppa gli articoli più importanti del bagno per dare un carattere originale e personalizzabile in base ad ogni esigenza estetica e funzionale. Le varie finiture disponibili danno la possibilità di creare ambienti unici, dal carattere deciso e molto moderno.**

**Scegli tra le varie finiture e forme della collezione e crea adesso il tuo nuovo stile!**

Creating harmony in the bathroom also means choosing coordinated products, which follow the same style and design, in order to develop a carefully studied and well-finished setting.

The Colour your Style collection brings together the most important bathroom products that give an original and customizable character to the bathroom, no matter the aesthetic and functional needs. The various finishes available make it possible to create unique settings with a strong and very modern personality.

Choose from the various finishes and shapes of the collection and create your new style now!

**aQuasanit®**

# Zefir

Eleganza unica per un bagno dal carattere raffinato

Unique elegance for a bathroom with a refined personality



gungrey



cromo  
chrome  
chrom  
chrome  
cromado



bianco opaco  
matt white  
mattes weiss  
blanc mate  
blanco mate



oro opaco  
matt gold  
mattes Gold  
doré mate  
oro mate

acciaio spazzolato  
brushed steel  
gebürsteter Stahl  
acier brossé  
acero cepillado

nero opaco  
matt black  
mattes schwarz  
noir mate  
negro mate

rame lucido  
shiny copper  
glänzendes Kupfer  
cuivre brillant  
cobre brillante





**Zefir è l'espressione di un'estetica progressista: stile all'avanguardia che non accetta compromessi, in grado di trasformare la serie nel protagonista del bagno e il bagno in un capolavoro perfetto che abbina il benessere alla funzionalità per un utilizzo confortevole.**

Zefir is the expression of a progressive aesthetic that does not forget the art of the past: avant-garde style that does not accept compromises and express a convincing design capable of transforming the series into the protagonist of the bathroom.



**Miscelatore monocomando lavabo alto, leva in metallo, cartuccia a dischi ceramici Ø 25 mm, flessibili inox 3/8F lunghezza 35 cm DVGW set di fissaggio**

Basin mixer, high size, metal lever, Ø 25 mm ceramic disc cartridge, 3/8F stainless steel flexible hoses, length 35 cm DVGW, assembly kit

Waschtischarmatur, Hebel aus Metall, Ø 25 mm Keramikkatusche, mit flexiblen Anschlussschläuchen 3/8F 35 cm aus EdelStahl DVGW, mit Fertigmontageset

Mitigeur lavabopoignée en métal, cartouche céramique Ø 25 mm, flexibles d'alimentation en acier inox 3/8F 35 cm DVGW, kit de montage fourni

Grifo monomando de lavabo alto, mango en metal, cartucho con discos cerámicos Ø 25 mm, flexos de conexión 3/8F 35 cm DVGW, juego de fijación

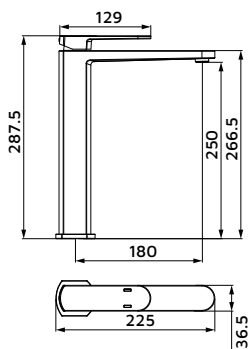

**SCARUB1360CR** ● cromo | chrome | chrom | chrome | cromado

**SCARUB1367NE** ● nero opaco | matt black | matten schwarz | noir mate | negro mate

**SCARUB1374BI** ○ bianco opaco | matt white | mattes weiss | blanc mate | blanco mate

**SCARUB1379AO** ● gungrey

**SCARUB1394AS** ● acciaio spazzolato | brushed steel | gebürsteter Stahl | acier brossé | acero cepillado

**SCARUB1384RA** ● rame lucido | shiny copper | glänzendes Kupfer | cuivre brillant | cobre brillante

**SCARUB1389RO** ● oro opaco | matt gold | mattes Gold | doré mate | oro mate



**Miscelatore monocomando lavabo, leva in metallo, cartuccia a dischi ceramici Ø 25 mm, completo di piletta in abs, flessibili inox 3/8F lunghezza 35 cm, set di fissaggio**

Basin mixer, metal lever, Ø 25 mm ceramic disc cartridge pop-up waste set, 3/8F stainless steel flexible hoses, length 35 cm, assembly kit

Waschtischarmatur, Hebel aus Metall, Ø 25 mm Keramikkatusche, mit Ablaufventil aus abs, mit flexiblen Anschlussschläuchen 3/8F 35 cm aus EdelStahl, mit Fertigmontageset

Mitigeur lavabo poignée en métal, cartouche céramique Ø 25 mm, avec garniture de vidage pop-up en abs, flexibles d'alimentation en acier inox 3/8F 35 cm, kit de montage fourni

Grifo monomando de lavabo, mango en metal, cartucho con discos cerámicos Ø 25 mm, desagüe pop-up 1"1/4 en abs, flexos de conexión 3/8F 35 cm, juego de fijación

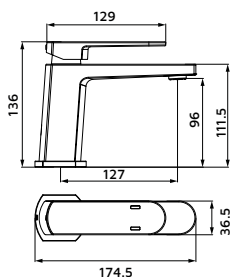

**SCARUB1358CR** ● cromo | chrome | chrom | chrome | cromado

**SCARUB1365NE** ● nero opaco | matt black | matten schwarz | noir mate | negro mate

**SCARUB1372BI** ○ bianco opaco | matt white | mattes weiss | blanc mate | blanco mate

**SCARUB1377AO** ● gungrey

**SCARUB1392AS** ● acciaio spazzolato | brushed steel | gebürsteter Stahl | acier brossé | acero cepillado

**SCARUB1382RA** ● rame lucido | shiny copper | glänzendes Kupfer | cuivre brillant | cobre brillante

**SCARUB1387RO** ● oro opaco | matt gold | mattes Gold | doré mate | oro mate

**Piletta saltarello per finitura cromo / Piletta click-clack per le altre finiture**  
Pop-up waste for chrome finish / Click-clack for the other finishes







**Miscelatore monocomando bidet, leva in metallo, cartuccia a dischi ceramici Ø 25 mm, completo di piletta pop-up da 1"1/4 in abs, flessibili inox 3/8F lunghezza 35 cm, set di fissaggio**

Bidet mixer, metal lever Ø 25 mm ceramic disc cartridge, ABS pop-up waste set, 3/8F stainless steel flexible hoses, length 35 cm, assembly kit

Bidetarmatur, Hebel aus Metall, Ø 25 mm Keramikkartusche, mit Ablaufventil aus abs, mit flexiblen Anschlussschläuchen 3/8F 35 cm aus Edelstahl, mit Fertigmontageset

Mitigeur bidet poignée en métal, cartouche céramique Ø 25 mm, avec garniture de vidage pop-up en abs, flexibles d'alimentation en acier inox 3/8F 35 cm, kit de montage fourni

Grifo monomando bidet, mango en metal, cartucho con discos cerámicos Ø 25 mm, desagüe pop-up 1"1/4 en abs, flexos de conexión 3/8F 35 cm, juego de fijación

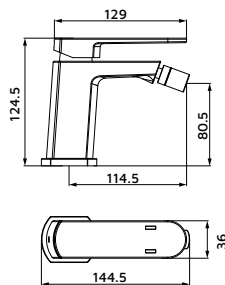

**SCARUB1359CR** ● cromo | chrome | chrom | chrome | cromado

**SCARUB1366NE** ● nero opaco | matt black | mattes schwarz | noir mate | negro mate

**SCARUB1373BI** ○ bianco opaco | matt white | mattes weiss | blanc mate | blanco mate

**SCARUB1378AO** ● gungrey

**SCARUB1393AS** ● acciaio spazzolato | brushed steel | gebürsteter Stahl | acier brossé | acero cepillado

**SCARUB1383RA** ● rame lucido | shiny copper | glänzendes Kupfer | cuivre brillant | cobre brillante

**SCARUB1388RO** ● oro opaco | matt gold | mattes Gold | doré mate | oro mate

**Piletta saltarello per finitura cromo / Piletta click-clack per le altre finiture**  
Pop-up waste for chrome finish / Click-clack for the other finishes



**Miscelatore monocomando vasca, leva in metallo, cartuccia a dischi ceramici Ø 25 mm, completo di raccordi eccentrici e rosette coprimuro**

Bath mixer, metal lever, Ø 25 mm ceramic disc cartridge, with union connectors and wall escutcheon

Wannenarmatur, Hebel aus Metall, Ø 25 mm Keramikkartusche mit S-Anschlüssen und Rosetten

Mitigeur bain, poignée en métal, cartouche céramique Ø 25 mm avec rosaces et raccords excentrés

Grifo monomando de bañera, mango en metal, cartucho con discos cerámicos Ø 25 mm, con excentricas y embellecedores incluidos

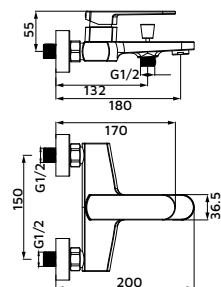

**SCARUB1361CR** ● cromo | chrome | chrom | chrome | cromado

**SCARUB1368NE** ● nero opaco | matt black | mattes schwarz | noir mate | negro mate

**SCARUB1405AO** ● gungrey

**SCARUB1406AS** ● acciaio spazzolato | brushed steel | gebürsteter Stahl | acier brossé | acero cepillado





**Miscelatore monocomando esterno doccia, leva in metallo, cartuccia a dischi ceramici Ø 25 mm, completo di raccordi eccentrici e rosette coprimuro**

Exposed shower mixer, metal lever, Ø 25 mm ceramic disc cartridge, with union connectors and wall escutcheon

Aufputz-Brausearmatur, Hebel aus Metall, Ø 25 mm Keramikkartusche, mit S-Anschlüssen und Rosetten

Mitigeur douche, poignée en métal, cartouche céramique Ø 25 mm, avec rosaces et raccords excentrés

Grifo monomando de ducha, mango en metal, cartucho con discos cerámicos Ø 25 mm, con excentricas y embellecedores incluidos

**SCARUB1362CR** ● cromo | chrome | chrom | chrome | cromado

**SCARUB1369NE** ● nero opaco | matt black | mattes schwarz | noir mate | negro mate

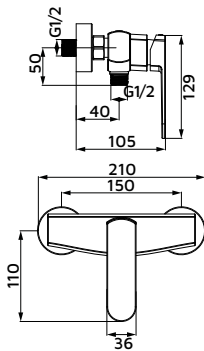

**Miscelatore monocomando incasso doccia, leva in metallo, cartuccia a dischi ceramici Ø 35 mm**

Concealed shower mixer, metal lever, Ø 35 mm ceramic disc cartridge

Unterputz-Brausearmatur, Hebel aus Metall, Ø 35 mm Keramikkartusche

Mitigeur douche à encastrer, poignée en métal, cartouche céramique Ø 35 mm

Grifo monomando de ducha, montaje empotrado, mango en metal, cartucho con discos cerámicos Ø 35 mm



**SCARUB1363CR** ● cromo | chrome | chrom | chrome | cromado

**SCARUB1370NE** ● nero opaco | matt black | mattes schwarz | noir mate | negro mate

**SCARUB1375BI** ○ bianco opaco | matt white | mattes weiss | blanc mate | blanco mate

**SCARUB1380AO** ● gungrey

**SCARUB1395AS** ● acciaio spazzolato | brushed steel | gebürsteter Stahl | acier brossé | acero cepillado

**SCARUB1385RA** ● rame lucido | shiny copper | glänzendes Kupfer | cuivre brillant | cobre brillante

**SCARUB1390RO** ● oro opaco | matt gold | mattes Gold | doré mate | oro mate

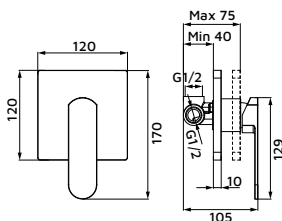

**Miscelatore monocomando incasso doccia con deviatore, cartuccia a dischi ceramici Ø 35 mm**



Concealed shower mixer with diverter, Ø 35 mm ceramic disc cartridge

Unterputz-Brausearmatur mit Umsteller, ø 35 mm Keramikkartusche

Mitigeur douche à encastrer, avec inverseur, cartouche céramique ø 35 mm

Grifo monomando de ducha, con inversor, montaje empotrado, mango en metal, cartucho con discos cerámicos Ø 35 mm

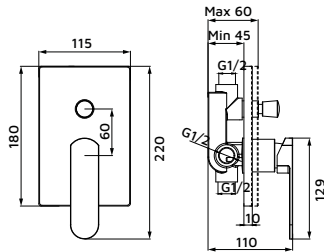

**SCARUB1364CR** ● cromo | chrome | chrom | chrome | cromado

**SCARUB1371NE** ● nero opaco | matt black | mattes schwarz | noir mate | negro mate

**SCARUB1376BI** ○ bianco opaco | matt white | mattes weiss | blanc mate | blanco mate

**SCARUB1381AO** ● gungrey

**SCARUB1396AS** ● acciaio spazzolato | brushed steel | gebürsteter Stahl | acier brossé | acero cepillado

**SCARUB1386RA** ● rame lucido | shiny copper | glänzendes Kupfer | cuivre brillant | cobre brillante

**SCARUB1391RO** ● oro opaco | matt gold | mattes Gold | doré mate | oro mate



**Piletta click-clack con troppo pieno | Click-clack drain waste with overflow | Click-Clack-Ablaufgarnitur mit Überlauf | Garniture de vidage clic-clack avec trop-plein | Desagüe click-clack con rebosadero**

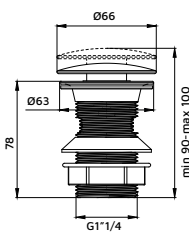

**SACPILO045CR** ● cromo | chrome | chrom | chrome | cromado

**SACPILO038NE** ● nero opaco | matt black | mattes schwarz | noir mate | negro mate

**SACPILO049BI** ○ bianco opaco | matt white | mattes weiss | blanc mate | blanco mate

**SACPILO050AO** ● gungrey

**SACPILO037AC** ● acciaio spazzolato | brushed steel | gebürsteter Stahl | acier brossé | acero cepillado

**SACPILO051RA** ● rame lucido | shiny copper | glänzendes Kupfer | cuivre brillant | cobre brillante

**SACPILO052RO** ● oro opaco | matt gold | mattes Gold | doré mate | oro mate

**Piletta click-clack senza troppo pieno | Click-clack drain waste without overflow | Click-Clack-Ablaufgarnitur ohne Überlauf | Garniture de vidage clic-clack sans trop-plein | Desagüe click-clack sin rebosadero**

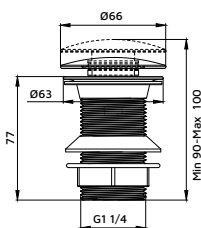

**SACPILO046CR** ● cromo | chrome | chrom | chrome | cromado

**SACPILO040NE** ● nero opaco | matt black | mattes schwarz | noir mate | negro mate

**SACPILO053BI** ○ bianco opaco | matt white | mattes weiss | blanc mate | blanco mate

**SACPILO054AO** ● gungrey

**SACPILO039AC** ● acciaio spazzolato | brushed steel | gebürsteter Stahl | acier brossé | acero cepillado

**SACPILO055RA** ● rame lucido | shiny copper | glänzendes Kupfer | cuivre brillant | cobre brillante

**SACPILO056RO** ● oro opaco | matt gold | mattes Gold | doré mate | oro mate

# Coral

Estetica progressista per uno stile all'avanguardia

Progressive aesthetics for a cutting-edge style



cromo  
chrome  
chrom  
chrome  
cromado



bianco opaco  
matt white  
mattes weiss  
blanc mate  
blanco mate



nero opaco  
matt black  
mattes schwarz  
noir mate  
negro mate



rame lucido  
shiny copper  
glänzendes Kupfer  
civre brillant  
cobre brillante



oro opaco  
matt gold  
mattes Gold  
doré mate  
oro mate



acciaio spazzolato  
brushed steel  
gebürsteter Stahl  
acier brossé  
acero cepillado

gungrey



**Grazie alle sue linee robuste la serie Coral impreziosisce e domina l'ambiente del bagno, creando un'attenta armonia degli spazi. L'elegante manopola senza leva è il tratto distintivo di questa particolare serie pensata per dare una forte identità a qualsiasi bagno.**

Thanks to its robust lines, the Coral series embellishes and dominates the bathroom, creating a careful harmony of spaces. The elegant leverless knob is the hallmark of this particular series designed to create a strong identity for any bathroom.



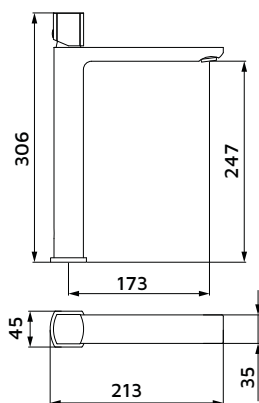

**Miscelatore monocomando lavabo alto, realizzato in ottone, manopola senza leva in metallo, rompigitto risparmio acqua (portata limitata a 6 l/min), cartuccia a dischi ceramici Ø 25 mm, con chiave di smontaggio aeratore inclusa, flessibili inox 3/8F lunghezza 40 cm certificati DVGW, set di fissaggio**

Basin mixer, high size, made of brass, metal knob without lever, water saving mousseur (capacity limited to 6 l/min), Ø 25 mm ceramic disc cartridge, mousseur key included, 3/8F stainless steel flexible hoses 40 cm DVGW certified, assembly kit

Waschtischarmatur, aus Messing, Knauf aus Metal ohne hebel, Mousseur Wassereinsparung (Kapazität auf 6 l/min begrenzt), Ø 25 mm Keramikkartusche, Wasserhahn Belüfter Schlüssel Einschließlich, mit flexiblen Anschlussschläuchen 3/8F 40 cm aus EdelStahl zertifiziert DVGW, montage-System

Mitigeur lavabo en laiton, bouton sans poignée en métal, mousseur pour économie d'eau (capacité limitée à 6 l/min), cartouche céramique Ø 25 mm, clé d'aérateur inclus, flexibles en acier inox 3/8F 40 cm certifiés DVGW, kit de montage

Grifo monomando de lavabo alto, en latón, mango en metal, aireador para ahorro de agua (caudal limitado a 6 l/min), cartucho con discos cerámicos Ø 25 cm, llave para montaje/desmontaje del aireador, flexos de conexión 3/8F 40 cm DVGW, juego de fijación

**SCARUB1339CR** ● cromo | chrome | chrom | chrome | cromado

**SCARUB1346NE** ● nero opaco | matt black | matten schwarz | noir mate | negro mate

**SCARUB1319BI** ○ bianco opaco | matt white | matten weiss | blanc mate | blanco mate

**SCARUB1334AO** ● gungrey

**SCARUB1355AS** ● acciaio spazzolato | brushed steel | gebürsteter Stahl | acier brossé | acero cepillado

**SCARUB1324RA** ● rame lucido | shiny copper | glänzendes Kupfer | cuivre brillant | cobre brillante

**SCARUB1227OR** ● oro opaco | matt gold | matten Gold | doré mate | oro mate



**Miscelatore monocomando lavabo, realizzato in ottone, manopola senza leva in metallo, rompigitto risparmio acqua (portata limitata a 6 l/min), cartuccia a dischi ceramici Ø 25 mm, piletta abs inclusa, con chiave di smontaggio rompigitto inclusa, flessibili inox 3/8F lunghezza 40 cm certificati DVGW, set di fissaggio**

Basin mixer, made of brass, metal knob without lever, water saving mousseur (capacity limited to 6 l/min), Ø 25 mm ceramic disc cartridge, with abs waste, mousseur key included, 3/8F stainless steel flexible hoses 40 cm DVGW, assembly kit

Waschtischarmatur, aus Messing, Knauf aus Metal ohne hebel, Mousseur Wassereinsparung (Kapazität auf 6 l/min begrenzt), Ø 25 mm Keramikkartusche, Ablaufventil abs, Wasserhahn Belüfter Schlüssel Einschließlich, mit flexiblen Anschlussschläuchen 3/8F 40 cm DVGW, montage-System

Mitigeur lavabo, en laiton, bouton sans poignée en métal, mousseur pour économie d'eau (capacité limitée à 6 l/min), cartouche céramique Ø 25 mm, garniture de vidage abs, clé d'aérateur inclus, flexibles d'alimentation en acier inox 3/8F 40 cm DVGW, kit de montage

Grifo monomando de lavabo, en latón, mango en metal, aireador para ahorro de agua (caudal limitado a 6 l/min), cartucho con discos cerámicos Ø 25 cm, llave para montaje/desmontaje del aireador, flexos de conexión 3/8F 40 cm DVGW, juego de fijación

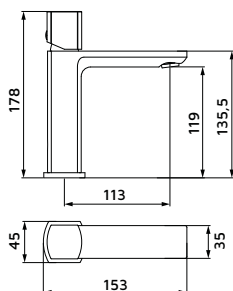

**SCARUB1337CR** ● cromo | chrome | chrom | chrome | cromado

**SCARUB1344NE** ● nero opaco | matt black | matten schwarz | noir mate | negro mate

**SCARUB1317BI** ○ bianco opaco | matt white | matten weiss | blanc mate | blanco mate

**SCARUB1332AO** ● gungrey

**SCARUB1353AS** ● acciaio spazzolato | brushed steel | gebürsteter Stahl | acier brossé | acero cepillado

**SCARUB1322RA** ● rame lucido | shiny copper | glänzendes Kupfer | cuivre brillant | cobre brillante

**SCARUB1225OR** ● oro opaco | matt gold | matten Gold | doré mate | oro mate

**Piletta saltarello per finitura cromo / Piletta click-clack per le altre finiture**  
Pop-up waste for chrome finish / Click-clack for the other finishes





**Miscelatore monocomando bidet, realizzato in ottone, manopola senza leva in metallo, rompigitto risparmio acqua (portata limitata a 6 l/min), cartuccia a dischi ceramici Ø 25 mm, piletta abs inclusa, flessibili inox 3/8F lunghezza 40 cm certificati DVGW, set di fissaggio**



Bidet mixer, made of brass, metal knob without lever, water saving mousseur (capacity limited to 6 l/min), Ø 25 mm ceramic disc cartridge, abs pop-up waste, 3/8F stainless steel flexible hoses 40 cm DVGW, assembly kit

Bidetarmatur, aus Messing, Knäuf aus Metal ohne hebel, Mousseur Wassereinsparung (Kapazität auf 6 l/min begrenzt), ø 25 mm Keramikkartusche, Ablaufventil abs, mit flexiblen Anschlussschläuchen 3/8F 40 cm, aus Edelstahl DVGW, mit Fertigmontageset

Mitigeur bidet en laiton, bouton sans poignée en métal, mousseur pour économie d'eau (capacité limitée à 6 l/min), cartouche céramique ø 25 mm, avec garniture de vidage abs, flexibles en acier inox 3/8F 40 cm DVGW, kit de montage

Grifo monomando bidet, en latón, mango en metal, aireador para ahorro de agua (caudal limitado a 6 l/min), cartucho con discos cerámicos Ø 25 cm, desagüe en abs, flexos de conexión 3/8F 40 cm DVGW, juego de fijación

**SCARUB1338CR** ● cromo | chrome | chrom | chrome | cromado

**SCARUB1345NE** ● nero opaco | matt black | mattes schwarz | noir mate | negro mate

**SCARUB1318BI** ○ bianco opaco | matt white | mattes weiss | blanc mate | blanco mate

**SCARUB1333AO** ● gungrey

**SCARUB1354AS** ● acciaio spazzolato | brushed steel | gebürsteter Stahl | acier brossé | acero cepillado

**SCARUB1323RA** ● rame lucido | shiny copper | glänzendes Kupfer | cuivre brillant | cobre brillante

**SCARUB1226OR** ● oro opaco | matt gold | mattes Gold | doré mate | oro mate

**Piletta saltarello per finitura cromo / Piletta click-clack per le altre finiture**  
Pop-up waste for chrome finish / Click-clack for the other finishes

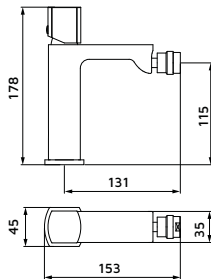

**Monocomando vasca, realizzato in ottone, manopola senza leva in metallo, rompigitto risparmio acqua (portata limitata a 6 l/min) cartuccia a dischi ceramici Ø 25 mm, completo di raccordi eccentrici e rosette coprimuro**



Bath mixer, made of brass, metal knob without lever, water saving mousseur (capacity limited to 6 l/min), Ø 25 mm ceramic disc 25 mm cartridge, with union connectors and wall escutcheon

Wannenarmatur, aus Messing, Knäuf aus Metall ohne hebel, Mousseur Wassereinsparung (Kapazität auf 6 l/min begrenzt), ø 25 mm Keramikkartusche, mit S-Anschlüssen und Rosetten

Mitigeur bain, en laiton, bouton sans poignée en métal, mousseur pour économie d'eau (capacité limitée à 6 l/min), cartouche céramique ø 25 mm, avec rosaces et raccords excentrés

Grifo monomando de bañera, en latón, mango en metal, aireador para ahorro de agua (caudal limitado a 6 l/min) aireador para ahorro de agua (caudal limitado a 6 l/min), cartucho con discos cerámicos Ø 25 cm, con excentricas y embellecedores incluidos

**SCARUB1340CR** ● cromo | chrome | chrom | chrome | cromado

**SCARUB1347NE** ● nero opaco | matt black | mattes schwarz | noir mate | negro mate

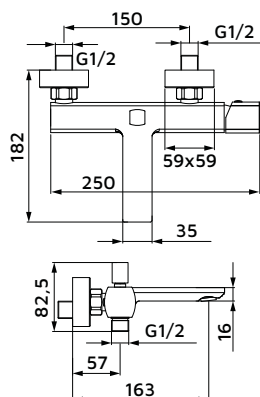

**Miscelatore monocomando esterno doccia, realizzato in ottone, manopola senza leva in metallo, cartuccia a dischi ceramici Ø 25 mm, completo di raccordi eccentrici e rosette coprimuro**

Exposed shower mixer, made of brass, metal knob without lever, Ø 25 mm ceramic disc cartridge, with union connectors and wall escutcheon

Aufputz-Brausearmatur, aus Messing, Knäuf aus Metal ohne hebel, ø 25 mm Keramikkartusche, mit S-Anschlüssen und Rosetten

Mitigeur douche en laiton, bouton sans poignée en métal, cartouche céramique ø 25 mm, avec rosaces et raccords excentrés

Grifo monomando de ducha, en latón, mango en metal, cartucho con discos cerámicos Ø 25cm, con excéntricas y embellecedores incluidos



**SCARUB1341CR** ● cromo | chrome | chrom | chrome | cromado

**SCARUB1348NE** ● nero opaco | matt black | mattes schwarz | noir mate | negro mate

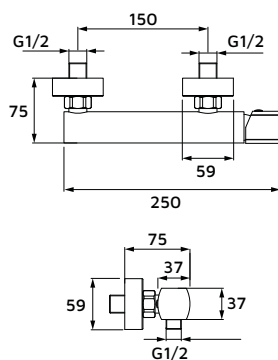

**Miscelatore monocomando incasso doccia, in ottone, leva in metallo, cartuccia a dischi ceramici Ø 25 mm**

Concealed shower mixer, made of brass, metal lever, Ø 25 mm ceramic disc cartridge

Unterputz-Brausearmatur, aus Messing, Hebel aus Metall, ø 25 mm Keramikkartusche

Mitigeur douche à encastrer, en laiton, poignée en métal, cartouche céramique ø 25 mm

Grifo monomando de ducha, montaje empotrado, en latón, mango en metal, cartucho con discos cerámicos Ø 25 cm



**SCARUB1342CR** ● cromo | chrome | chrom | chrome | cromado

**SCARUB1349NE** ● nero opaco | matt black | mattes schwarz | noir mate | negro mate

**SCARUB1320BI** ○ bianco opaco | matt white | mattes weiss | blanc mate | blanco mate

**SCARUB1335AO** ● gungrey

**SCARUB1356AS** ● acciaio spazzolato | brushed steel | gebürsteter Stahl | acier brossé | acero cepillado

**SCARUB1325RA** ● rame lucido | shiny copper | glänzendes Kupfer | cuivre brillant | cobre brillante

**SCARUB1230OR** ● oro opaco | matt gold | mattes Gold | doré mate | oro mate

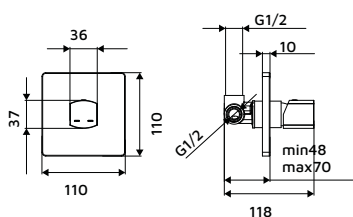

### Miscelatore monocomando incasso doccia con deviatore, in ottone, cartuccia a dischi ceramici Ø 25 mm

Concealed shower mixer with diverter, made of brass, Ø 25 mm ceramic disc cartridge

Unterputz-Brausearmatur mit Umsteller, aus Messing, ø 25 mm Keramikkartusche

Mitigeur douche à encastrer avec inverseur bain/douche, en laiton, cartouche céramique ø 25 mm

Grifo monomando de ducha, de dos vías, para baño y ducha, montaje empotrado, en latón, mango en metal, cartucho con discos cerámicos Ø 25 cm

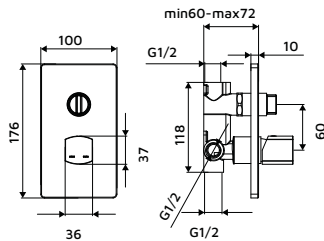

**SCARUB1343CR** ● cromo | chrome | chrom | chrome | cromado

**SCARUB1350NE** ● nero opaco | matt black | mattes schwarz | noir mate | negro mate

**SCARUB1321BI** ○ bianco opaco | matt white | mattes weiss | blanc mate | blanco mate

**SCARUB1336AO** ● gungrey

**SCARUB1357AS** ● acciaio spazzolato | brushed steel | gebürsteter Stahl | acier brossé | acero cepillado

**SCARUB1326RA** ● rame lucido | shiny copper | glänzendes Kupfer | cuivre brillant | cobre brillante

**SCARUB1231OR** ● oro opaco | matt gold | mattes Gold | doré mate | oro mate



### Piletta click-clack con troppo pieno | Click-clack drain waste with overflow | Click-Clack-Ablaufgarnitur mit Überlauf | Garniture de vidage clic-clack avec trop-plein | Desagüe click-clack con rebosadero

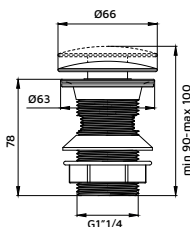

**SACPILO045CR** ● cromo | chrome | chrom | chrome | cromado

**SACPILO038NE** ● nero opaco | matt black | mattes schwarz | noir mate | negro mate

**SACPILO049BI** ○ bianco opaco | matt white | mattes weiss | blanc mate | blanco mate

**SACPILO050AO** ● gungrey

**SACPILO037AC** ● acciaio spazzolato | brushed steel | gebürsteter Stahl | acier brossé | acero cepillado

**SACPILO051RA** ● rame lucido | shiny copper | glänzendes Kupfer | cuivre brillant | cobre brillante

**SACPILO052RO** ● oro opaco | matt gold | mattes Gold | doré mate | oro mate

### Piletta click-clack senza troppo pieno | Click-clack drain waste without overflow | Click-Clack-Ablaufgarnitur ohne Überlauf | Garniture de vidage clic-clack sans trop-plein | Desagüe click-clack sin rebosadero

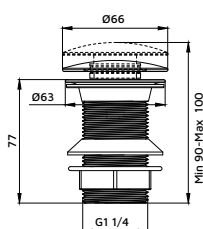

**SACPILO046CR** ● cromo | chrome | chrom | chrome | cromado

**SACPILO040NE** ● nero opaco | matt black | mattes schwarz | noir mate | negro mate

**SACPILO053BI** ○ bianco opaco | matt white | mattes weiss | blanc mate | blanco mate

**SACPILO054AO** ● gungrey

**SACPILO039AC** ● acciaio spazzolato | brushed steel | gebürsteter Stahl | acier brossé | acero cepillado

**SACPILO055RA** ● rame lucido | shiny copper | glänzendes Kupfer | cuivre brillant | cobre brillante

**SACPILO056RO** ● oro opaco | matt gold | mattes Gold | doré mate | oro mate





## Atlas

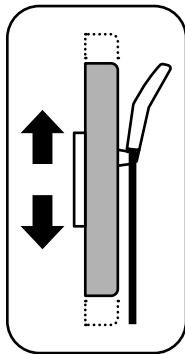
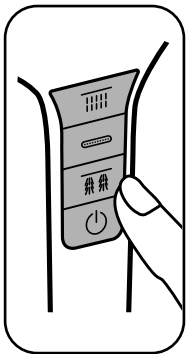

Set saliscendi, alluminio, doccia abs, 3 getti, anticalcare, 13x13 cm, pulsanti integrati nel manico per selezionare e fermare i getti, attacco universale da 1/2", asta doccia rettangolare scorrevole in altezza su guida, lunghezza 75,5 cm, supporto doccia inclinabile, flessibile acciaio doppia aggraffatura, lunghezza 150 cm

Shower rail set, aluminium, hand shower, ABS, 3 sprays, anti-limescale, 13x13 cm, buttons integrated in the handle to select and stop the jets, water-saving seal (water flow limiter 9 litres/minute), universal connector 1/2", rectangular shower rail, sliding in height on guide, length 75,5 cm, reclinable shower holder, steel shower hose double lock, length 150 cm

Brausegarnitur aus Aluminium, handbrause aus ABS, 3 Strahlarten, Antikalk-System, 13x13 cm, im Griff integrierte Tasten zum Anwählen und Stoppen der Strahlarten, Regulierung des Wasserverbrauchs (Durchflussbegrenzer 9 l/min), universellem Anschluss 1/2", rechteckige Duschstange Höhenverstellbar auf Führung, Länge 75,5 cm, neigbarer Brausehalter, doppelt gewickelter Brauseschlauch aus Stahl, Länge 150 cm

Ensemble de douche en aluminium, douchette en ABS, 3 jets, anti-calcaire, 13x13 cm, boutons intégrés dans la poignée pour sélectionner et arrêter les jets, avec un joint spécial pour l'économie d'eau (réducteur de débit 9 l/mn), raccord universel 1/2", barre de douche rectangulaire coulissante en hauteur sur guide, longueur 75,5 cm, support de douche inclinable, flexible douche double agrafage en acier longueur 150 cm

Conjunto de ducha, aluminio, teleducha, ABS, 3 chorros, antical, 13x13 cm, botones integrados en el mango para seleccionar y parar los chorros, junta para ahorro de agua (caudal limitado a 9 l/min), conexión universal 1/2", barra de ducha rectangular deslizante en altura sobre guía, longitud 75,5 cm, soporte de ducha inclinable, flexo en acero grapado doble 150 cm

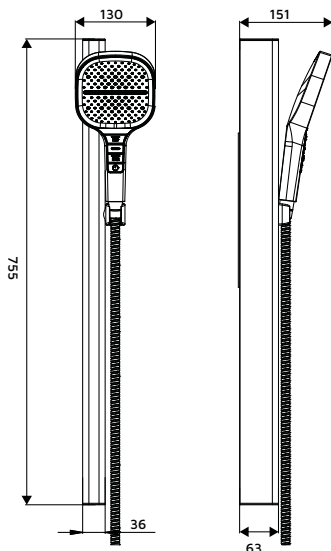

**SAPSAL0160CR** ● cromo | chrome | chrom | chrome | cromado

**SAPSAL0161NE** ● nero opaco | matt black | matten schwarz | noir mate | negro mate

**SAPSAL0165BI** ○ bianco opaco | matt white | matten weiss | blanc mate | blanco mate

**SAPSAL0163AC** ● gungrey

**SAPSAL0170AS** ● acciaio spazzolato | brushed steel | gebürsteter Stahl | acier brossé | acero cepillado

**SAPSAL0167RA** ● rame lucido | shiny copper | glänzendes Kupfer | cuivre brillant | cobre brillante

**SAPSAL0168RO** ● oro opaco | matt gold | matten Gold | doré mate | oro mate





## Atlas

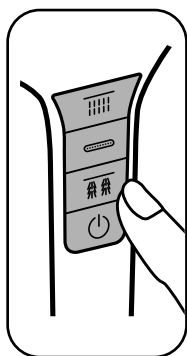

**Doccia, ABS, 3 getti, anticalcare, 13x13 cm, pulsanti integrati nel manico per selezionare e fermare i getti, guarnizione risparmio acqua (portata limitata a 9 l/min), attacco universale da 1/2"**

Hand shower, ABS, 3 sprays, anti-limescale, 13x13 cm, buttons integrated in the handle to select and stop the jets, water-saving seal (water flow limiter 9 litres/minute), universal connector 1/2"

Handbrause aus ABS, 3 Strahlarten, Antikalk-System, 13x13 cm, im Griff integrierte Tasten zum Anwählen und Stoppen der Strahlarten, Regulierung des Wasserverbrauchs (Durchflussbegrenzer 9 l/min), universellem Anschluss 1/2"

Douchette en ABS, 3 jets, anti-calcaire, 13x13 cm, boutons intégrés dans la poignée pour sélectionner et arrêter les jets, avec un joint spécial pour l'économie d'eau (réducteur de débit 9 l/mn) , raccord universel 1/2"

Teleducha, ABS, 3 chorros, antical, 13x13 cm, botones integrados en el mango para seleccionar y parar los chorros, junta para ahorro de agua (caudal limitado a 9 l/min), conexión universal 1/2"

**SAPDOC0290CR** ● cromo | chrome | chrom | chrome | cromado

**SAPDOC0291NE** ● nero opaco | matt black | matten schwarz | noir mate | negro mate

**SAPDOC0300BI** ○ bianco opaco | matt white | matten weiss | blanc mate | blanco mate

**SAPDOC0295AC** ● gungrey

**SAPDOC0306AS** ● acciaio spazzolato | brushed steel | gebürsteter Stahl | acier brossé | acero cepillado

**SAPDOC0302RA** ● rame lucido | shiny copper | glänzendes Kupfer | cuivre brillant | cobre brillante

**SAPDOC0304RO** ● oro opaco | matt gold | matten Gold | doré mate | oro mate

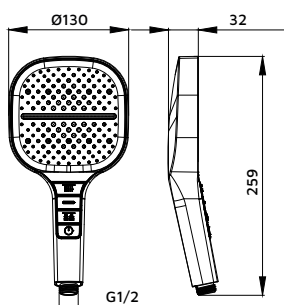







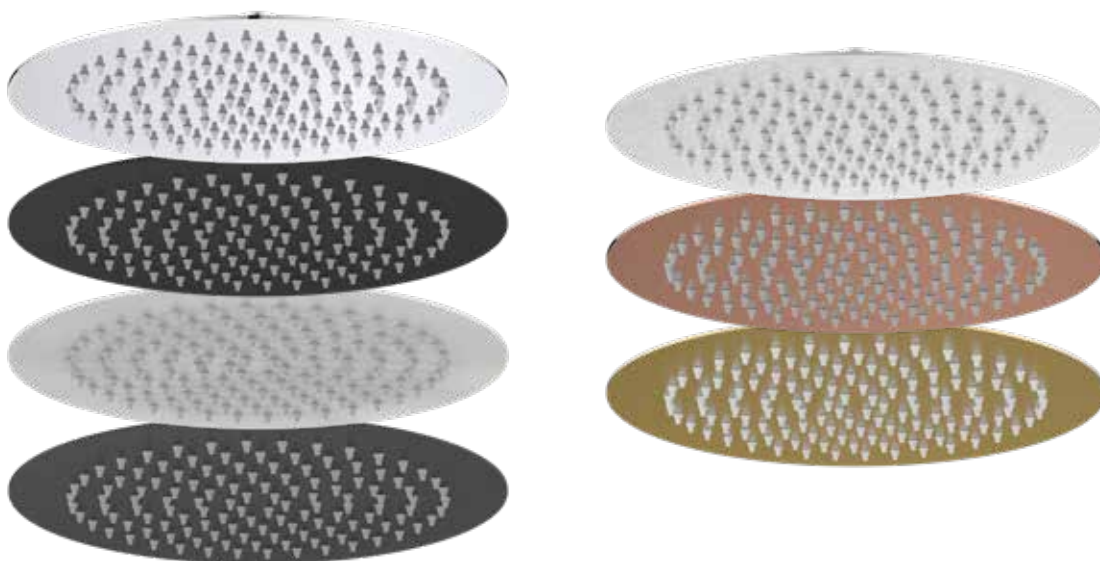

## Cometa tondo

Soffione, acciaio SS304, Ø 25 cm, ultraslim, 1 getto, anticalcare, attacco snodabile universale da 1/2"

Shower head, steel SS304, Ø 25 cm, ultraslim, 1 spray, anti-limescale, universal flexible connector 1/2"

Extra flache Kopfbrause aus Stahl SS304, Ø 25 cm, 1 Strahlart, Antikalk-System, mit universellem Anschluss 1/2"

Douche de tête superplate en acier SS304, Ø 25 cm, 1 jet, système anti-calcaire, raccord universel flexible 1/2"

Rociador, acero SS304, ultraslim, Ø 25 cm, 1 chorro, antical, conexión articulada universal 1/2"

**SAPSOF0108CR** ● cromo | chrome | chrom | chrome | cromado

**SAPSOF0109NE** ● nero opaco | matt black | mattes schwarz | noir mate | negro mate

**SAPSOF0110BI** ○ bianco opaco | matt white | mattes weiss | blanc mate | blanco mate

**SAPSOF0111AO** ● gungrey

**SAPSOF0114AS** ● acciaio spazzolato | brushed steel | gebürsteter Stahl | acier brossé | acero cepillado

**SAPSOF0112RA** ● rame lucido | shiny copper | glänzendes Kupfer | cuivre brillant | cobre brillante

**SAPSOF0113RO** ● oro opaco | matt gold | mattes Gold | doré mate | oro mate

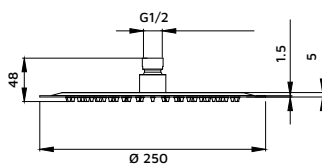

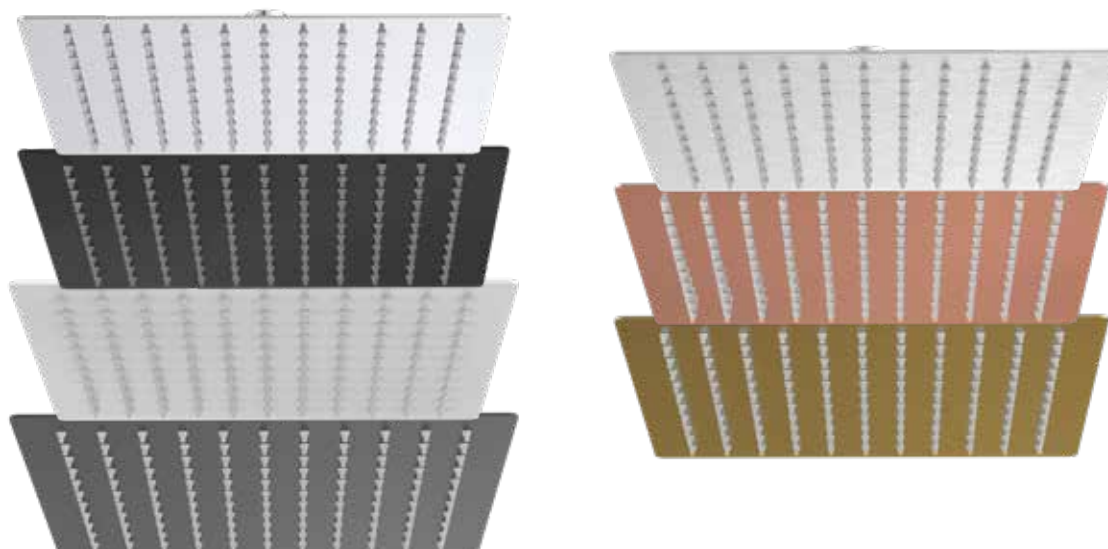

## Cometa quadro

**Soffione, acciaio SS304, 25 x 25 cm, ultraslim, 1 getto, anticalcare, attacco snodabile universale da 1/2"**

Shower head, steel SS304, 25 x 25 cm, ultraslim, 1 spray, anti-limescale, universal flexible connector 1/2"

Extra flache Kopfbrause aus Stahl SS304, 25 x 25 cm, 1 Strahlart, Antikalk-System, mit universellem Anschluss 1/2"

Douche de tête superplate en acier SS304, 25 x 25 cm, 1 jet, système anti-calcaire, raccord universel flexible 1/2"

Rociador, acero SS304, 25 x 25 cm, ultraslim, 1 chorro, antical, conexión articulada universal 1/2"

**SAPSOF0116CR** ● cromo | chrome | chrom | chrome | cromado

**SAPSOF0117NE** ● nero opaco | matt black | mattes schwarz | noir mate | negro mate

**SAPSOF0118BI** ○ bianco opaco | matt white | mattes weiss | blanc mate | blanco mate

**SAPSOF0119AO** ● gungrey

**SAPSOF0122AS** ● acciaio spazzolato | brushed steel | gebürsteter Stahl | acier brossé | acero cepillado

**SAPSOF0120RA** ● rame lucido | shiny copper | glänzendes Kupfer | cuivre brillant | cobre brillante

**SAPSOF0121RO** ● oro opaco | matt gold | mattes Gold | doré mate | oro mate

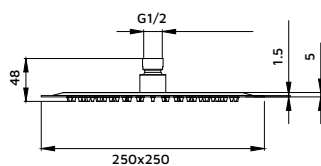





## Braccio doccia tondo 30 cm

**Braccio doccia, installazione a parete, acciaio inox 304  
attacco universale da 1/2"**

Shower arm, wall-mounted, made of stainless steel 304  
universal mounting system 1/2"

Brausearm aus 304 Edelstahl, zur Wandmontage  
mit universellem Anschluss 1/2"

Bras de douche en acier inoxydable 304, pour fixation murale  
raccord universel 1/2"

Brazo de ducha, acero inoxidable SS304, instalación a pared  
conexión universal 1/2"

**SAPBRA0046CR** ● cromo | chrome | chrom | chrome | cromado

**SAPBRA0047NE** ● nero opaco | matt black | mattes schwarz | noir mate | negro mate

**SAPBRA0048BI** ○ bianco opaco | matt white | mattes weiss | blanc mate | blanco mate

**SAPBRA0049AO** ● gungrey

**SAPBRA0052AS** ● acciaio spazzolato | brushed steel | gebürsteter Stahl | acier brossé | acero cepillado

**SAPBRA0050RA** ● rame lucido | shiny copper | glänzendes Kupfer | cuivre brillant | cobre brillante

**SAPBRA0051RO** ● oro opaco | matt gold | mattes Gold | doré mate | oro mate

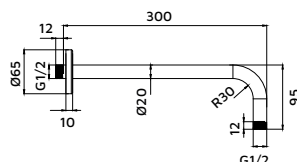

## Braccio doccia quadro 30 cm

**Braccio doccia, installazione a parete, acciaio inox 304  
attacco universale da 1/2"**

Shower arm, wall-mounted, made of stainless steel 304  
universal mounting system 1/2"

Brausearm aus 304 Edelstahl, zur Wandmontage  
mit universellem Anschluss 1/2"

Bras de douche en acier inoxydable 304, pour fixation murale  
raccord universel 1/2"

Brazo de ducha, acero inoxidable SS304, instalación a pared  
conexión universal 1/2"

**SAPBRA0054CR** ● cromo | chrome | chrom | chrome | cromado

**SAPBRA0055NE** ● nero opaco | matt black | mattes schwarz | noir mate | negro mate

**SAPBRA0056BI** ○ bianco opaco | matt white | mattes weiss | blanc mate | blanco mate

**SAPBRA0057AO** ● gungrey

**SAPBRA0060AS** ● acciaio spazzolato | brushed steel | gebürsteter Stahl | acier brossé | acero cepillado

**SAPBRA0058RA** ● rame lucido | shiny copper | glänzendes Kupfer | cuivre brillant | cobre brillante

**SAPBRA0059RO** ● oro opaco | matt gold | mattes Gold | doré mate | oro mate

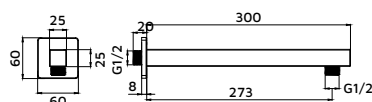



## Flessibile acciaio 150 cm

**Flessibile acciaio inox, doppia aggraffatura, lunghezza 150 cm attacco conico universale 1/2"**

Steel flexible hose, double lock, length 150 cm conic universal connector 1/2"

Flexschlauch aus Stahl, doppelt gewickelt, Länge 150 cm mit Konus-Anschluss 1/2"

Flexible en acier, double agrafage, longueur 150 cm avec raccord conique 1/2"

Flexo de ducha, acero, doble grapado, longitud 150 cm conexión universal 1/2"

**SAPFLE0101CR** ● cromo | chrome | chrom | chrome | cromado

**SAPFLE0102NE** ● nero opaco | matt black | mattes schwarz | noir mate | negro mate

**SAPFLE0100BI** ○ bianco opaco | matt white | mattes weiss | blanc mate | blanco mate

**SAPFLE0098AO** ● gungrey

**SAPFLE0105AC** ● acciaio spazzolato | brushed steel | gebürsteter Stahl | acier brossé | acero cepillado

**SAPFLE0103RA** ● rame lucido | shiny copper | glänzendes Kupfer | cuivre brillant | cobre brillante

**SAPFLE0104RO** ● oro opaco | matt gold | mattes Gold | doré mate | oro mate



## Flessibile pvc 150 cm

**Flessibile pvc rinforzato, lunghezza 150 cm, attacco conico universale 1/2"**

Reinforced PVC flexible hose, length 150 cm, conic universal connector 1/2"

Flexschlauch aus PVC, Länge 150 cm, mit Konus-Anschluss 1/2"

Flexible en PVC renforcé, longueur 150 cm, avec raccord conique 1/2"

Flexo de ducha, PVC reforzando, longitud 150 cm, conexión universal 1/2"

**SAPFLE0111CR** ● cromo | chrome | chrom | chrome | cromado

**SAPFLE0112NE** ● nero opaco | matt black | mattes schwarz | noir mate | negro mate

**SAPFLE0107BI** ○ bianco opaco | matt white | mattes weiss | blanc mate | blanco mate

**SAPFLE0108AO** ● gungrey

**SAPFLE0115AS** ● acciaio spazzolato | brushed steel | gebürsteter Stahl | acier brossé | acero cepillado

**SAPFLE0109RA** ● rame lucido | shiny copper | glänzendes Kupfer | cuivre brillant | cobre brillante

**SAPFLE0110RO** ● oro opaco | matt gold | mattes Gold | doré mate | oro mate





## Pres a acqua tonda

Pres a d'acqua, realizzata in ottone, attacco universale da 1/2"

Water connection, made of brass, universal connector 1/2"

Anschlussventil, aus Messing, mit S-Anschlüssen 1/2"

Vanne à passage, en laiton, raccord universel 1/2"

Toma de agua, en latón, conexión universal 1/2"

**SAPDOC0308CR** ● cromo | chrome | chrom | chrome | cromado

**SAPDOC0312NE** ● nero opaco | matt black | mattes schwarz | noir mate | negro mate

**SAPDOC0298BI** ○ bianco opaco | matt white | mattes weiss | blanc mate | blanco mate

**SAPDOC0297AO** ● gungrey

**SAPDOC0331AS** ● acciaio spazzolato | brushed steel | gebürsteter Stahl | acier brossé | acero cepillado

**SAPDOC0303RA** ● rame lucido | shiny copper | glänzendes Kupfer | cuivre brillant | cobre brillante

**SAPDOC0327RO** ● oro opaco | matt gold | mattes Gold | doré mate | oro mate

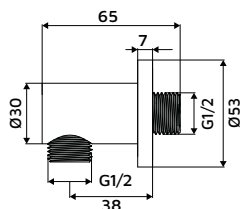

## Pres a acqua quadra

Pres a d'acqua, realizzata in ottone, attacco universale da 1/2"

Water connection, made of brass, universal connector 1/2"

Anschlussventil, aus Messing, mit S-Anschlüssen 1/2"

Vanne à passage, en laiton, raccord universel 1/2"

Toma de agua, en latón, conexión universal 1/2"

**SAPDOC0309CR** ● cromo | chrome | chrom | chrome | cromado

**SAPDOC0313NE** ● nero opaco | matt black | mattes schwarz | noir mate | negro mate

**SAPDOC0318BI** ○ bianco opaco | matt white | mattes weiss | blanc mate | blanco mate

**SAPDOC0321AO** ● gungrey

**SAPDOC0332AS** ● acciaio spazzolato | brushed steel | gebürsteter Stahl | acier brossé | acero cepillado

**SAPDOC0324RA** ● rame lucido | shiny copper | glänzendes Kupfer | cuivre brillant | cobre brillante

**SAPDOC0328RO** ● oro opaco | matt gold | mattes Gold | doré mate | oro mate

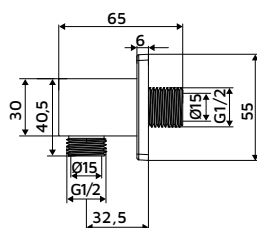



## Pres a acqua tonda con supporto

Pres a d'acqua, realizzata in ottone, con supporto doccia attacco universale da 1/2"

Water connection, made of brass, with hand shower holder universal connector 1/2"

Anschlussventil, aus Messing, mit Brausehalter, mit S-Anschlüssen 1/2"

Vanne à passage, en laiton, avec support de douche, raccord universel 1/2"

Toma de agua, en latón, con soporte de ducha, conexión universal 1/2"

**SAPDOC0310SU** ● cromo | chrome | chrom | chrome | cromado

**SAPDOC0314SU** ● nero opaco | matt black | mattes schwarz | noir mate | negro mate

**SAPDOC0319SU** ○ bianco opaco | matt white | mattes weiss | blanc mate | blanco mate

**SAPDOC0322AO** ● gungrey

**SAPDOC0333AS** ● acciaio spazzolato | brushed steel | gebürsteter Stahl | acier brossé | acero cepillado

**SAPDOC0325RA** ● rame lucido | shiny copper | glänzendes Kupfer | cuivre brillant | cobre brillante

**SAPDOC0329RO** ● oro opaco | matt gold | mattes Gold | doré mate | oro mate

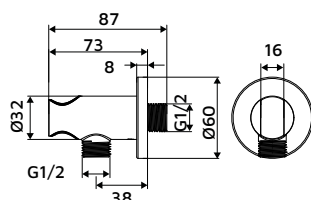

## Pres a acqua quadra con supporto

Pres a d'acqua, realizzata in ottone, attacco universale da 1/2"

Water connection, made of brass, universal connector 1/2"

Anschlussventil, aus Messing, mit S-Anschlüssen 1/2"

Vanne à passage, en laiton, raccord universel 1/2"

Toma de agua, en latón, conexión universal 1/2"

**SAPDOC0311SU** ● cromo | chrome | chrom | chrome | cromado

**SAPDOC0315SU** ● nero opaco | matt black | mattes schwarz | noir mate | negro mate

**SAPDOC0320SU** ○ bianco opaco | matt white | mattes weiss | blanc mate | blanco mate

**SAPDOC0323AO** ● gungrey

**SAPDOC0334AS** ● acciaio spazzolato | brushed steel | gebürsteter Stahl | acier brossé | acero cepillado

**SAPDOC0326RA** ● rame lucido | shiny copper | glänzendes Kupfer | cuivre brillant | cobre brillante

**SAPDOC0330RO** ● oro opaco | matt gold | mattes Gold | doré mate | oro mate

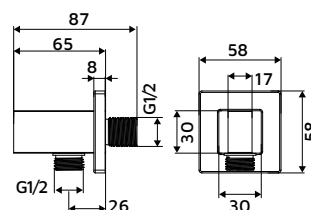



**aQuasanit®**

**IDRO-BRIC S.p.A**  
Via dell'Industria, 4/b  
24040 Casirate d'Adda (BG) - Italy  
Tel. +39 0363 326690  
Fax +39 0363 326710  
[www.idrobric.it](http://www.idrobric.it)  
[www.aquasanit.it](http://www.aquasanit.it)